

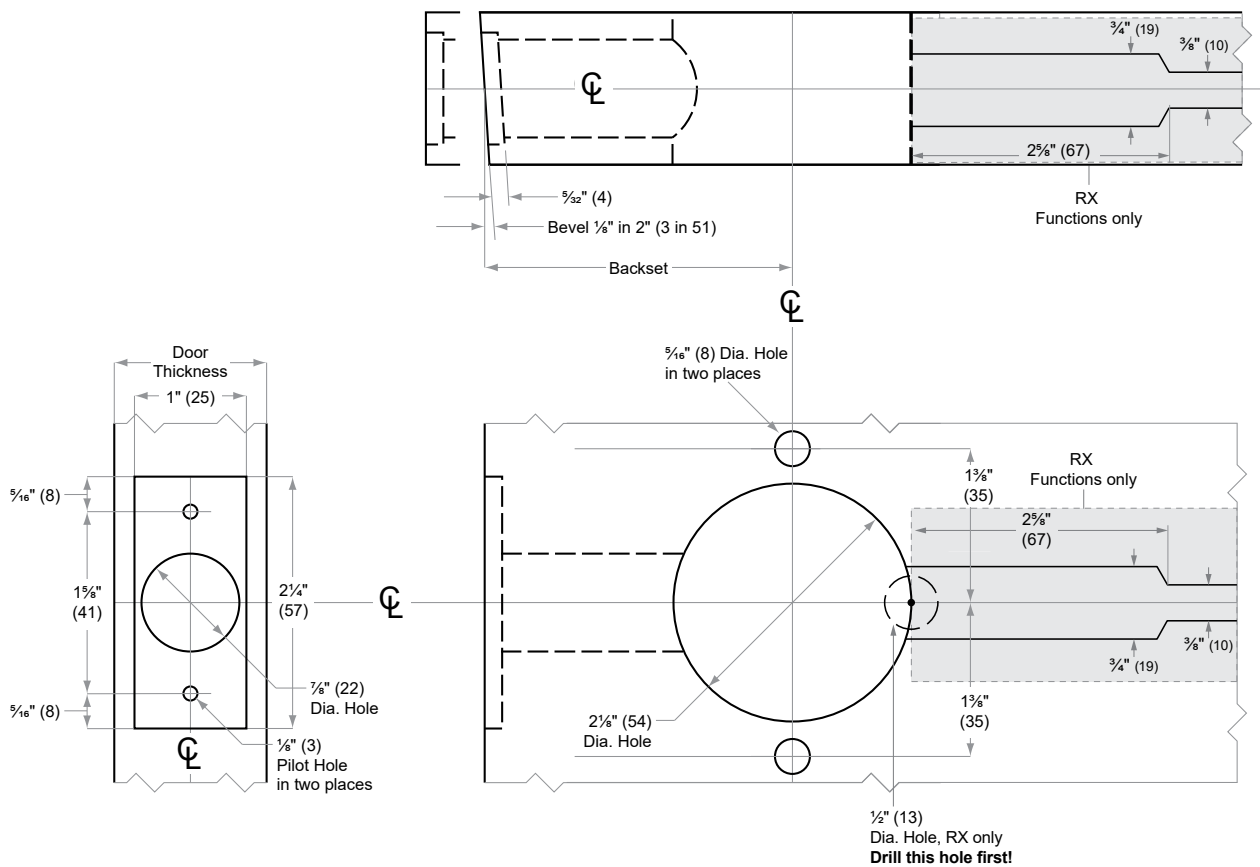

PC-Series

Models PC10– PC80

Door Type: Wood or Composite, Flat or Beveled
Door Thickness: 1 3/8" (35 mm)– 1 3/4" (44 mm)
Faceplate: Square Corner, 1" (25 mm) wide
Backsets: 2 3/8" (60 mm), 2 3/4" (70 mm)



Dimensions shown in parentheses () are in millimeters.

Door preparation template