

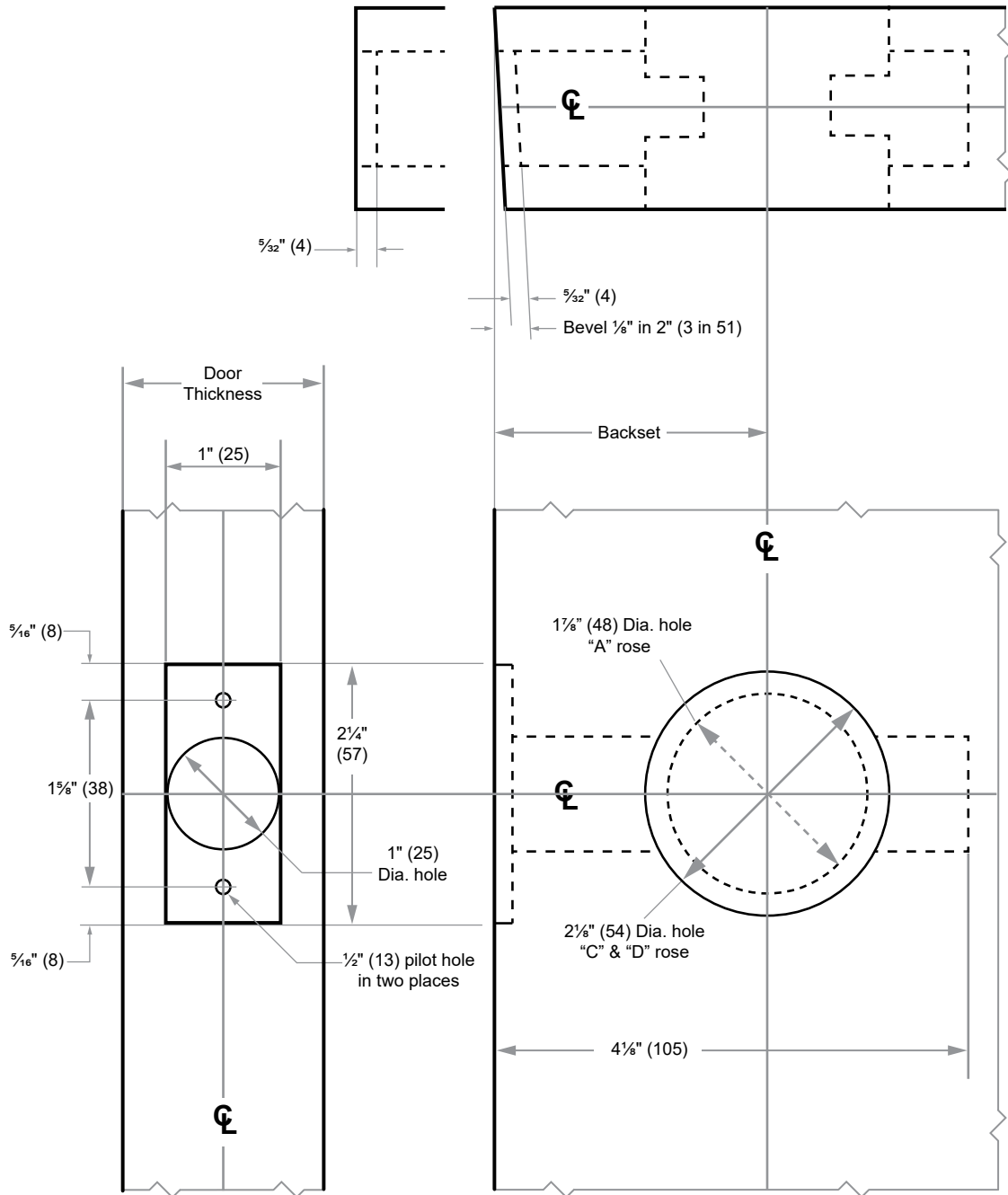

# PT-Series

## Models PT10, PT40

**Door Type:** Wood or Composite, Flat or beveled  
**Door Thickness:** 1 $\frac{3}{8}$ " (35 mm)–2" (51 mm)  
**Faceplate:** Square Corner, 1" (25 mm) wide  
**Backsets:** 2 $\frac{3}{8}$ " (60 mm)



Dimensions shown in parentheses ( ) are in millimeters.

Door preparation template